

DANA-FARBER CANCER INSTITUTE
Longwood campus

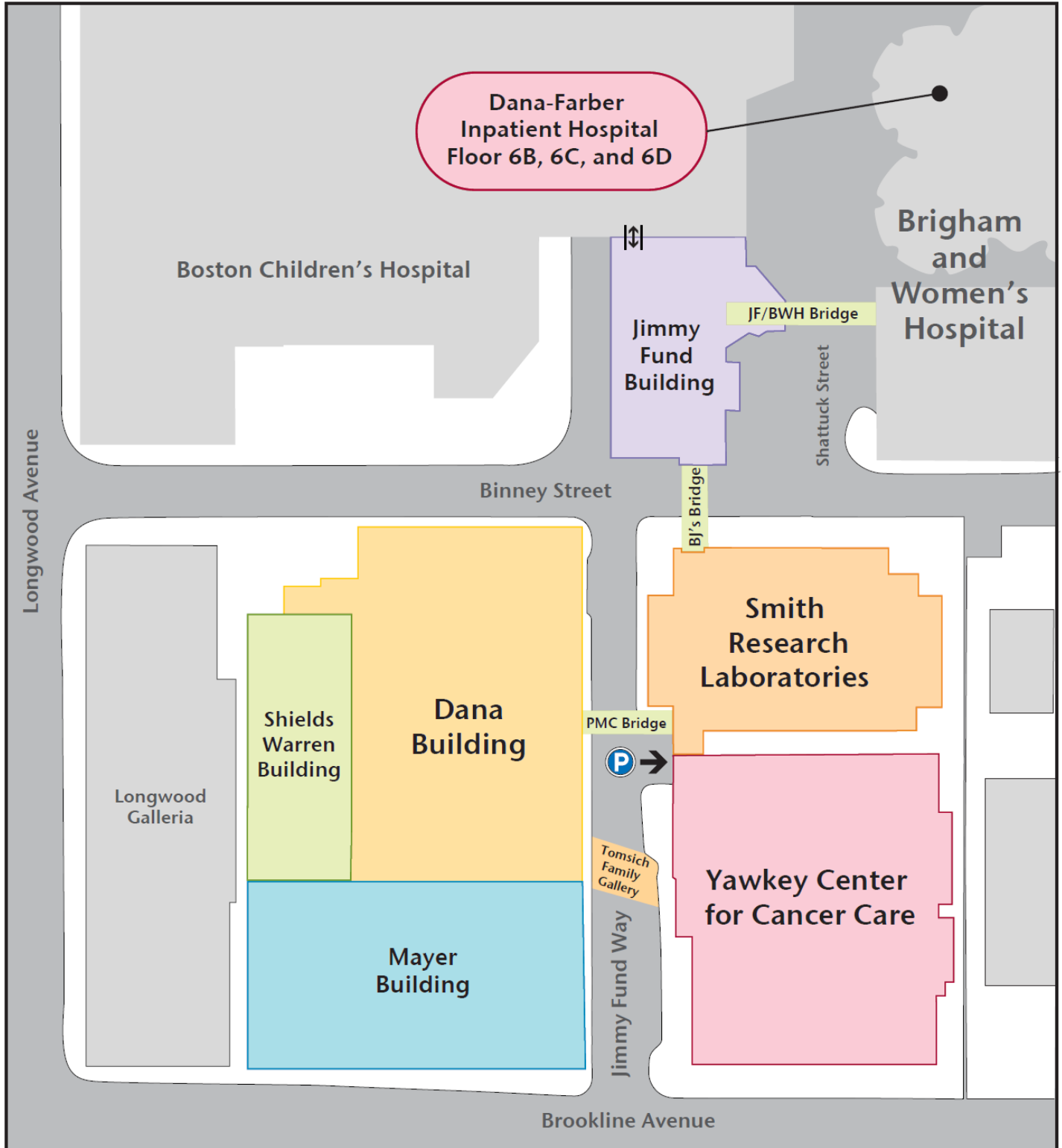

YAWKEY Floor P1

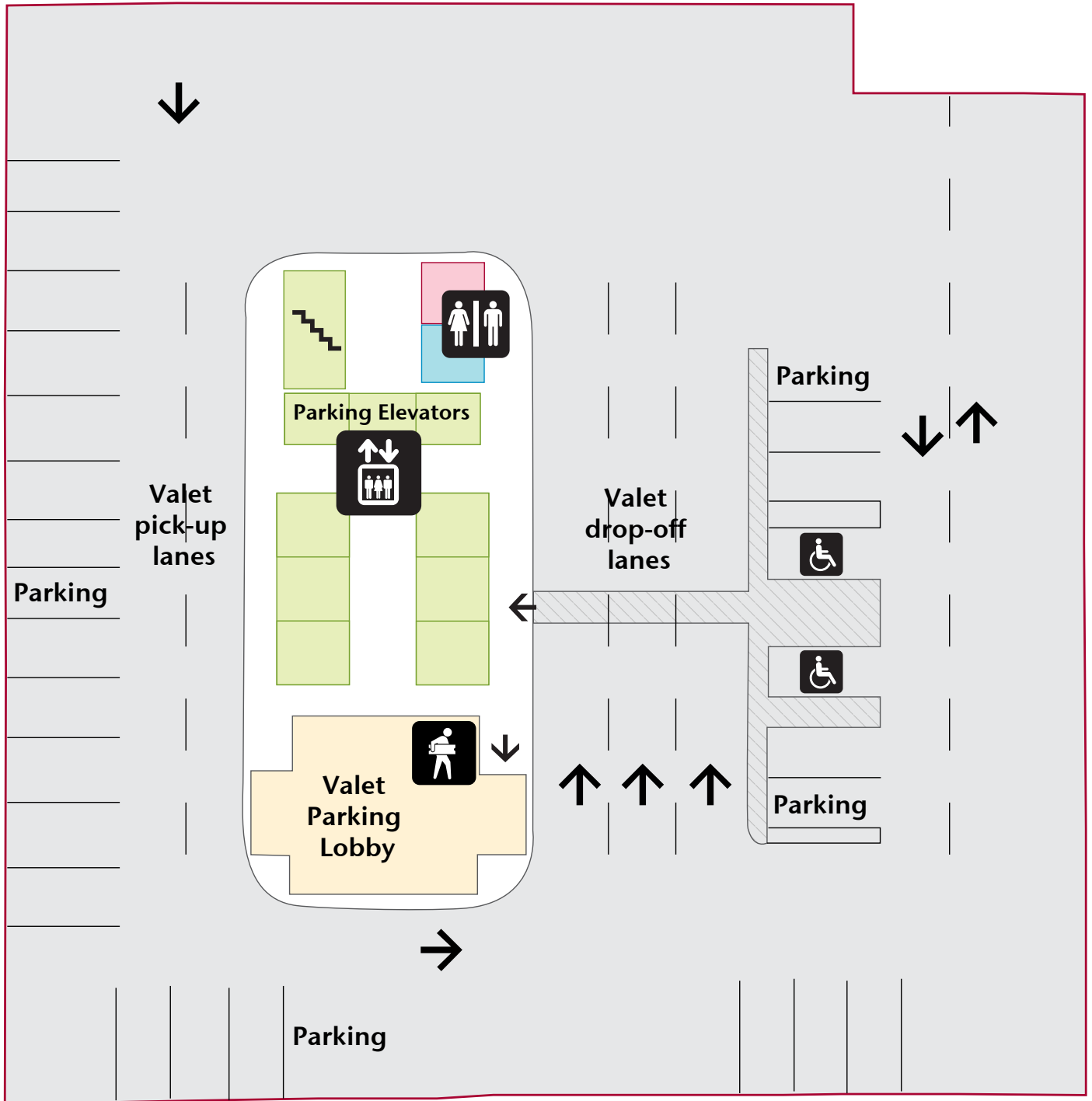

Parking Pay Station

YAWKEY Floor 1

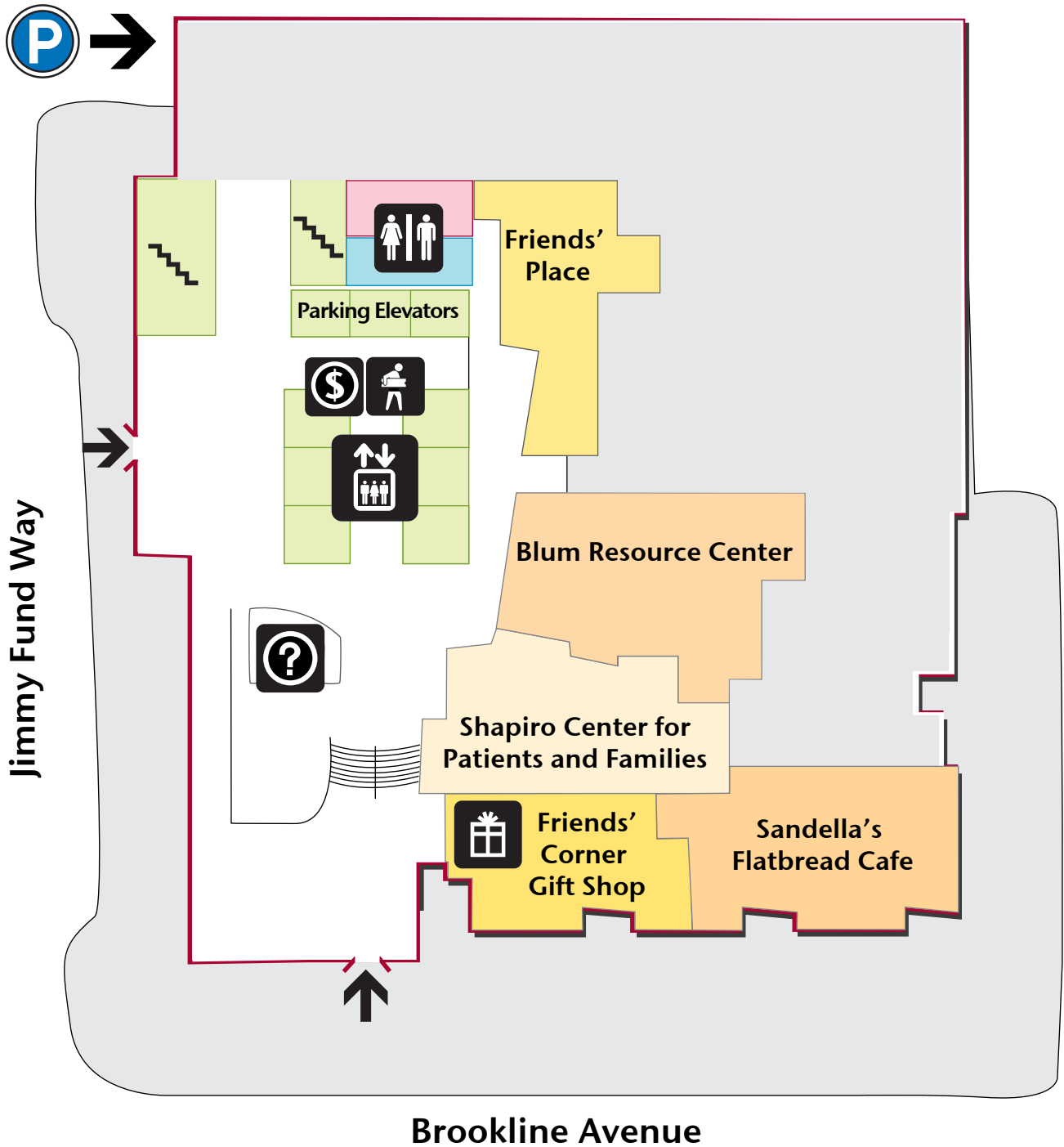

YAWKEY Floor 2

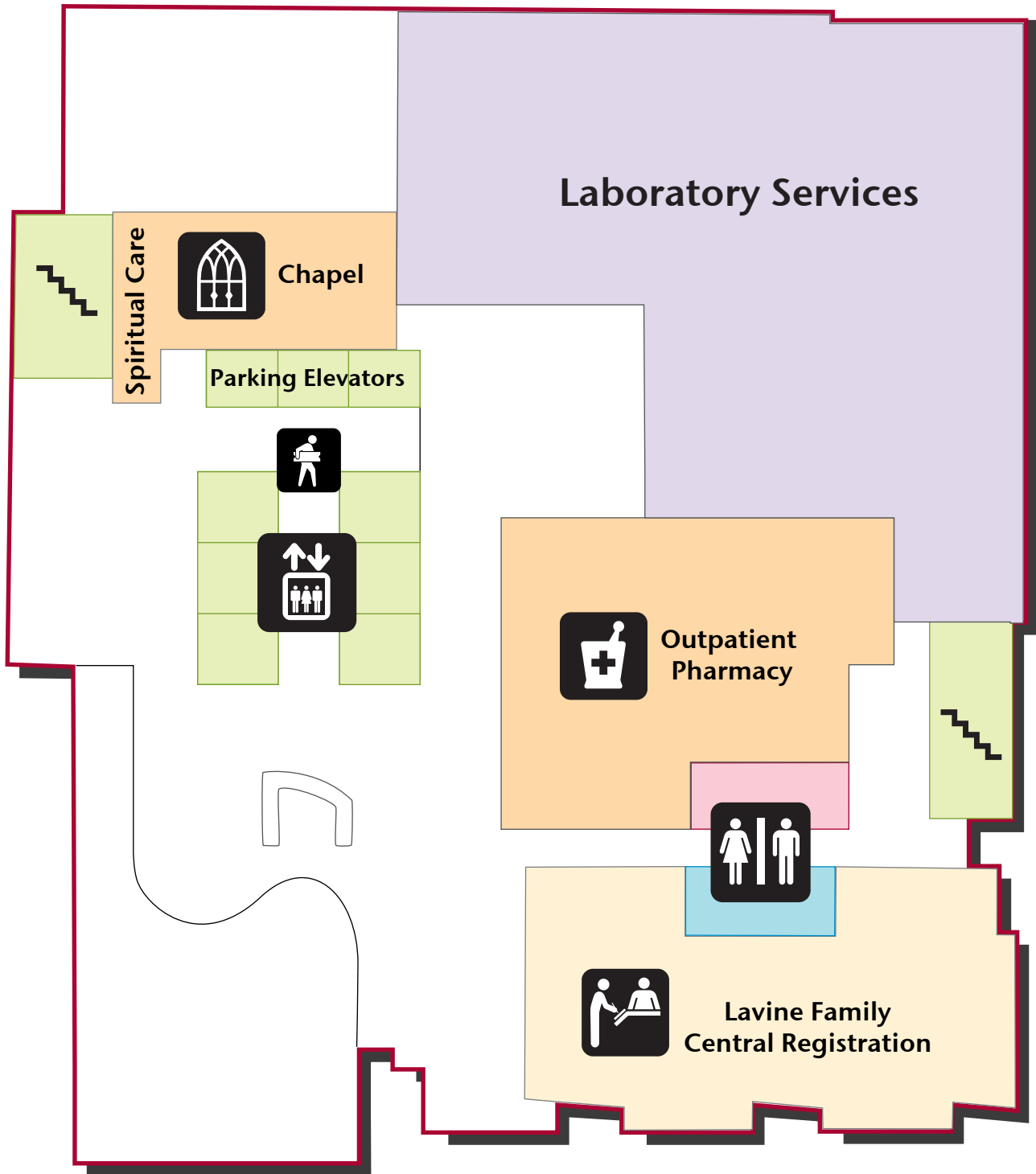

YAWKEY Floor 3

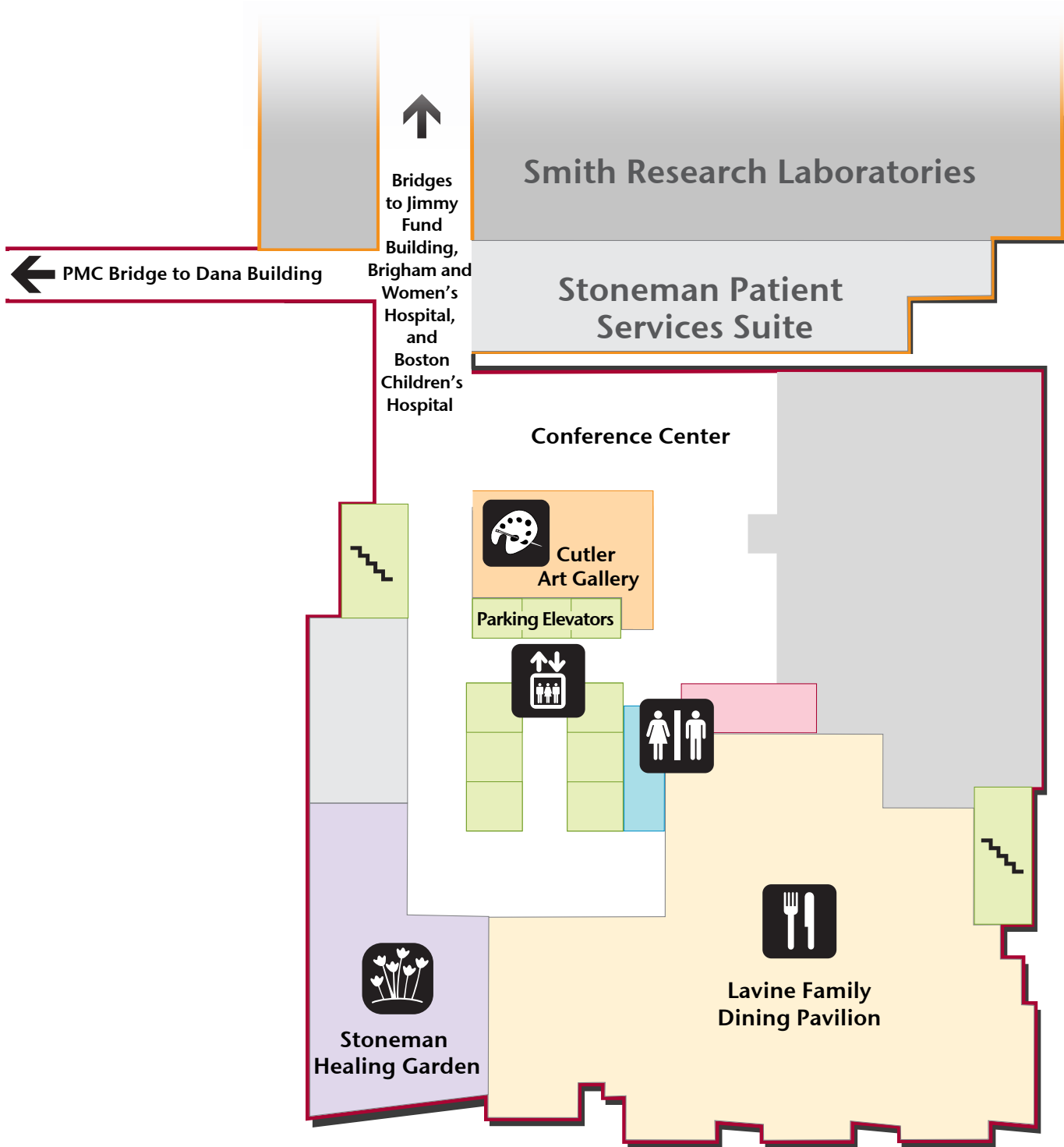

YAWKEY Standard Clinical Floor Floors 5-11

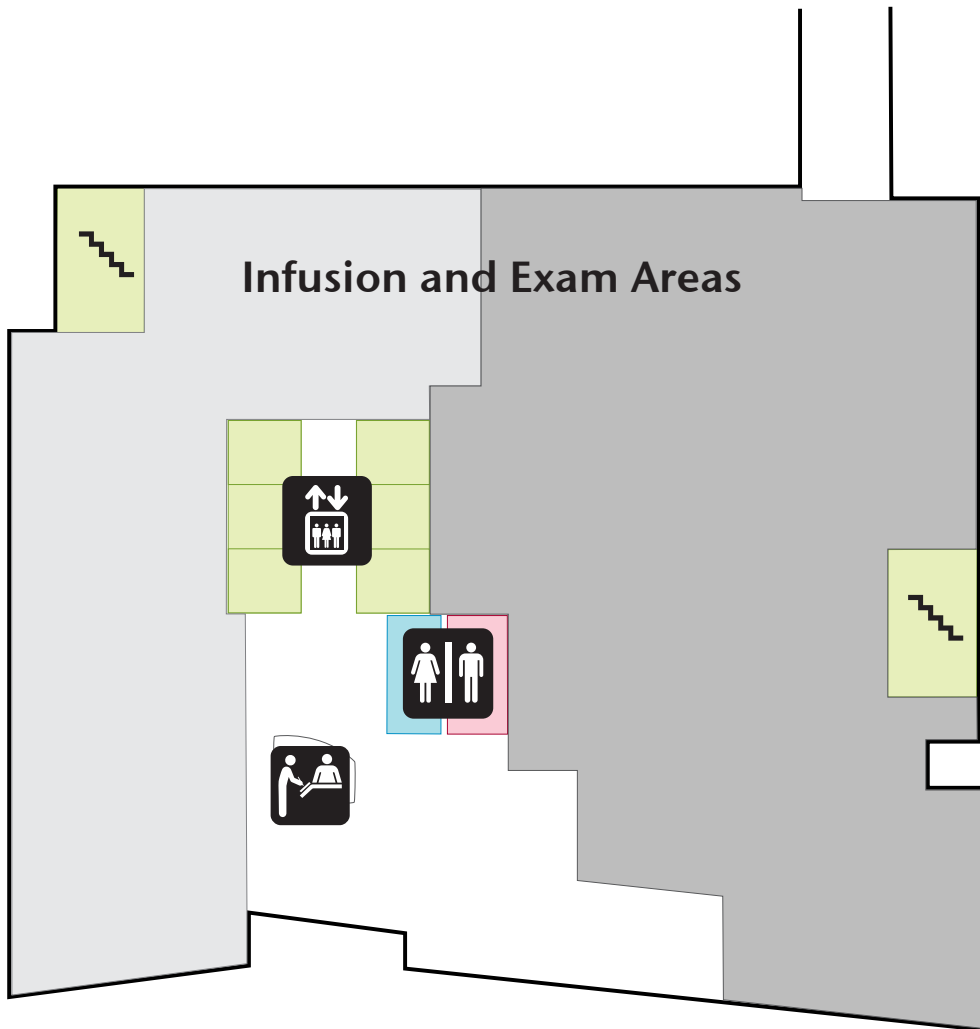

Dana-Farber Cancer Institute, Longwood Campus

All locations are in the Yawkey Center, unless otherwise noted.

Bridges to hospitals	via 3rd floor bridge	Hematologic Malignancies	7, 8
Boston Children's Hospital		Hematology	8
Brigham and Women's Hospital		<i>Lank</i> Imaging	Dana L1
Dana-Farber Inpatient Hospital		Information	1
Registration		Jimmy Fund Clinic	Dana 3
<i>Lavine Family</i> Central Registration	2	Laboratory Services	2
Imaging and Radiation		Leukemia	8
Oncology Registration	Dana L2	<i>Bekenstein Family</i> Atrium Lobby	1
Pediatric Registration	Dana 3	<i>Lubin</i> Lobby	2
Cancer Genetics and Prevention	9	Lymphoma	8
Chapel	2	Melanoma	11
Clinical Research Center	6	<i>Lipper</i> Center for Multiple Myeloma	7
Concierge Services (<i>Shapiro</i> Center)	1	Neuro-Oncology	10
<i>Yawkey</i> Conference Center	3	Nuclear Medicine	Dana L2
Cutaneous Oncology	11	Adult Palliative Care	11
<i>Cutler</i> Art Gallery	3	Parking Elevators	P2, P1, 1, 2, 3
<i>Boston Red Sox Jimmy Fund</i> Auditorium	Jimmy Fund G	Parking Valet/Cashier	P1
<i>Kraft Family</i> Blood Donor Center	Jimmy Fund 1	Patient and Family Drop-off/Pick-up	P1
Breast Oncology	9	<i>Blum</i> Patient and Family Resource Center	1
Desensitization Unit	11	<i>Blum</i> Pediatric Resource Room	Dana 2
<i>Lavine Family</i> Dining Pavilion	3	Outpatient Pharmacy	2
Early Drug Development	6	Radiation Oncology	Dana L2
<i>Friends'</i> Corner Gift Shop	1	Sarcoma and Bone Oncology	6
<i>Friends'</i> Place	1	<i>Shapiro</i> Center for Patients and Families	1
Gastrointestinal Oncology	7	Spiritual Care (Chaplains)	2
<i>Lank</i> Center for Genitourinary Oncology	11	Stem Cell Transplantation	8
Gynecologic Oncology	10	<i>Lowe</i> Center for Thoracic Oncology	10
Head and Neck Oncology	11	<i>Susan F. Smith</i> Center for Women's Cancers	9, 10
<i>Stoneman</i> Healing Garden	3	<i>Zakim</i> Center for Integrative Therapies	6

Patient & Family Resources

Locations listed here are in the Yawkey Center, unless otherwise noted.

<i>Cutler Art Gallery</i>	3
Chapel	2
Concierge Services (<i>Shapiro Center</i>)	1
Corner Deli	1
<i>Lavine Family Dining Pavilion</i>	3
Financial Counseling	2
<i>Friends' Corner Gift Shop</i>	1
<i>Friends' Place</i>	1
<i>Stoneman Healing Garden</i>	3
Jazzman's Cafe and Bakery	Dana 1
Outpatient Pharmacy	2
<i>Blum Patient and Family Resource Center</i>	1
<i>Shapiro Center for Patients and Families</i>	1
<i>Blum Pediatric Resource Room</i>	Dana 3
Spiritual Care (Chaplains)	2